

1000 TV-LINE OUTDOOR DAY/NIGHT BULLET CAMERA WITH ADVANCED DWDR

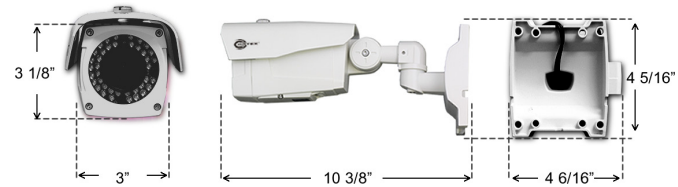

KEY BENEFITS

- MEGA CVBS
- WIDE DYNAMIC RANGE
- 3D DIGITAL NOISE REDUCTION
- POWERFUL INFRARED LEDS
- WIDE-RANGING POWER TOLERANCE
- CONTROLLABLE IR LED BRIGHTNESS



MODEL : COR-600HIM

SPECIFICATIONS

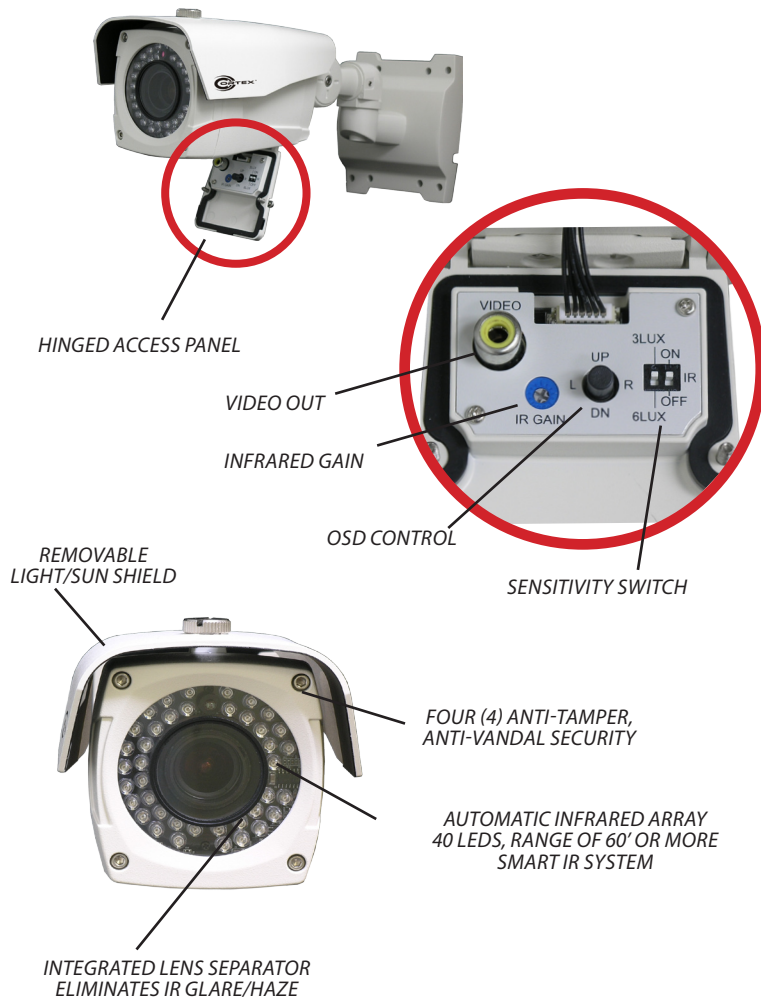

MODEL	ECL-600HIM
Video Sensor	1/3" SONY™ CMOS 1.4MP
Resolution	1000TV lines
Lens (option)	DC auto iris lens or ICR Filter change DC auto iris lens (2.8~12mm, 3.5~16mm, 6~50mm)
Illumination Range	0.8 LUX, f1.2 (color) 0.0 LUX with IR on 0.001 LUX, (b/w, sens-up x256 in OSD)
White Balance	Auto / Pushing / Manual
Backlight	Off / BLC / WDR
IR LED Array	Round 40pcs (30deg)
Signal Processing	HKE DSP chipset
Shutter	AUTO / MANUAL (1/25(30)~1/60,000 sec)
Gain Control	Yes - Auto and Manual, OSD adjustable
Wide Dynamic Range	Yes (advanced WDR)
Digital Noise Reduction	Off / Low / Middle / High
Mechanical IR Filter	Day/night ICR-IR cut filter
Effective Pixels	1305(H) x 1049(V) 1.37M pixels
Scanning system	Progressive
Image Control	Sharpness, color control and more in OSD menu
Privacy	Yes, 16 areas
Day / Night	Auto / Color / B&W / EXTERN
Weatherproof Rating	IIP67, good for indoor/outdoor placement
Vandal Resistance	Solid metal case
Power	12VDC (sold separately)
Power / Consumption	Dual Type (DC:Max. 8W, AC:Max. 10W) / DC Type (Max. 6W)
Housing	Corrosion resistant design
Dimension(inches)(mm)	10 3/8" (L) x 3.0" (W, w/o sunshield) x 4 5/16" (H)
Weight	1.1Kg 2.4(pounds)
Operating Temperature	-10 C~+50 C (Fan / Heater type -40 C~+70 C) / 30%~80% RH
Storage Temperature	-20 C~+60 C / 20%~90% RH
Motion Detection	Off / On



ADVANCED TECHNOLOGY AT YOUR COMMAND

WWW.CCTVCORE.COM